

JHN08



Material M材質	Hardness 硬度
SKH-51	HRC59°-61°

■入口直徑・α的計算式
formula of entrance diameter*α

$$\alpha = 2SR + 2(L-G-SR)\tan\frac{A}{2}$$

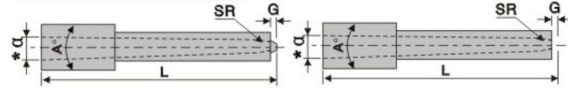

- *P尺寸端部有0.2的直段
- SR都放電精加工
- At the top of "P" has 0-0.2's straight.
- SR part discharge process.
- D與P的偏心0.05以下
- D與V的偏心0.05以下
- D and P's eccentricity below 0.05.
- D and V's eccentricity below 0.05.

1A形狀/shape

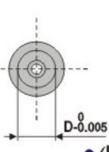
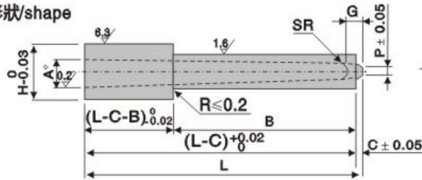

● (L-C-B) ≥ 3.0

■前端放大圖
top zoom in

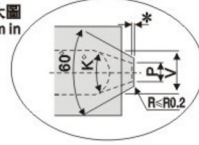

2A形狀/shape

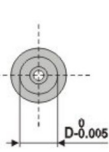
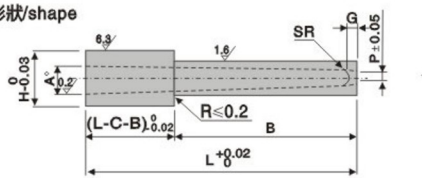

● (L-B) ≥ 3.0

■前端放大圖
top zoom in

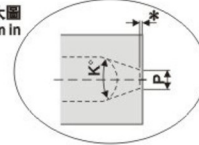

3A形狀/shape

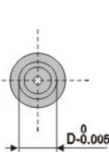
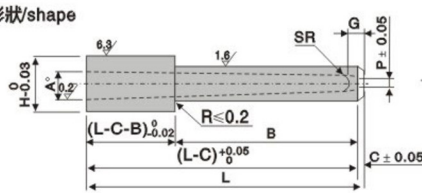

● (L-C-B) ≥ 3.0

■前端放大圖
top zoom in

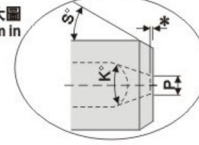

4A形狀/shape

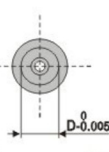
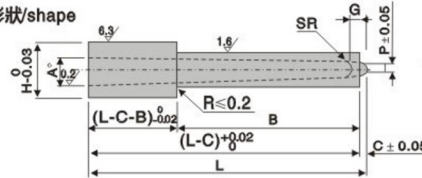

● (L-C-B) ≥ 3.0

■前端放大圖
top zoom in

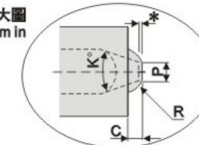

5A形狀/shape

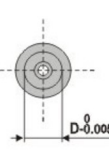
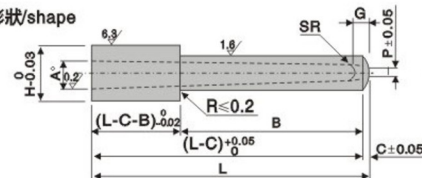

● (L-C-B) ≥ 3.0

■前端放大圖
top zoom in

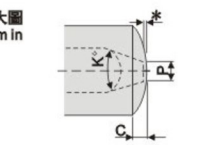

點式澆口套-SKH-51- POINT SPRUE BUSHING

塑膠模用
PLASTIC mold accessories

Catalog No.		D	0.01mm unit L	P	A°	K°	B		沒有2A形狀 Without 2A 0.1mm unit C	僅有1A形狀 Only 1A 0.1mm unit V	僅有3A形狀 Only 3A 1° unit S°	僅有4A形狀 Only 4A 0.1mm unit R	H	G	SR									
Type	Shape						不漸給定 No need unit BT037-1	0.01mm unit BT037-2																
B尺寸固定型 B size fixed JHN08-1	1A	2	6.00-20.00	0.3 0.4	1 2 3	20	3	3.00-5.00	0.2-0.4	1.3-1.9		0.4-0.8	3	0.7	0.60									
		2.5	8.00-25.00	0.3 0.4 0.5	1 2 3			4								4.00-6.00	0.2-0.5	1.5-2.4		0.6-1.0	4	1	0.75	
		3		0.5 0.6 0.8	1 2 3																			6
	2A	4	10.00-40.00	0.6	1 2 3		6		6.00-30.00 6.00-20.00 6.00-30.00	0.3-0.8	2.5-3.9	1-45	0.8-1.5	6	1.2									
		3A	5		0.8 1.0			1 2 3								6	6.00-20.00 6.00-35.00					1.25		
			4A	6	15.00-60.00			1.0															1 2 3	10
	5A			8			1.2 1.4	1 2 3	10	6.00-40.00 6.00-40.00 6.00-30.00	0.5-1.5	4.0-5.9	1-50	1.5-3.0	9								1.5	
		5A		8			1.2 1.4	1 2 3								10	6.00-50.00		4.5-7.9	1-60	2.0-4.0	11		
			8		1.6		1 2 3	10																6.00-50.00

C尺寸僅1A 3A 4A 5A形狀有，V尺寸僅1A形狀有，S角度僅3A形狀有，R尺寸僅4A形狀有。
BT037-2時：(L-C-B) ≥ 3.0 2A形狀時 (L-B) ≥ 3.0。
C size only for 3A 4A 5A, V size only for 1A, S angle only for 3A, R size only for 4A.
BT037-2: (L-C-B) ≥ 3.0 2A(L-B) ≥ 3.0.

B尺寸固定型/B size fixed

Catalog No.		D	L	@/P(1-4P)				
Type	D			1A	2A	3A	4A	5A
JHN08-1	2	6.00-20.00	18,720	17,290	17,580	18,720	18,720	
	2.5	8.00-25.00	18,720	17,290	17,580	18,720	18,720	
	3	10.00-25.00	13,110	11,690	11,970	13,110	13,110	
		25.01-40.00	14,060	12,640	12,920	14,060	14,060	
	4	10.00-25.00	13,400	11,970	12,260	13,400	13,400	
		25.01-40.00	14,160	12,730	13,020	14,160	14,160	
	5	15.00-25.00	12,830	11,400	11,690	12,830	12,830	
		25.01-40.00	13,400	11,970	12,260	13,400	13,400	
	6	40.01-60.00	14,160	12,730	13,020	14,160	14,160	
		15.00-25.00	12,830	11,400	11,690	12,830	12,830	
	8	25.01-40.00	13,680	12,260	12,540	13,680	13,680	
		40.01-60.00	14,540	13,110	13,400	14,540	14,540	

B尺寸給定型/B size appointed

Catalog No.		D	L	@/P(1-4P)				
Type	D			1A	2A	3A	4A	5A
JHN08-2	2	6.00-20.00	20,430	19,000	19,290	20,430	20,430	
	2.5	8.00-25.00	20,430	19,000	19,290	20,430	20,430	
	3	10.00-25.00	14,250	12,830	13,110	14,250	14,250	
		25.01-40.00	15,300	13,870	14,160	15,300	15,300	
	4	10.00-25.00	14,630	13,210	13,490	14,630	14,630	
		25.01-40.00	15,390	13,970	14,250	15,390	15,390	
	5	15.00-25.00	13,970	12,540	12,830	13,970	13,970	
		25.01-40.00	14,630	13,210	13,490	14,630	14,630	
	6	40.01-60.00	15,390	13,970	14,250	15,390	15,390	
		15.00-25.00	13,970	12,540	12,830	13,970	13,970	
	8	25.01-40.00	14,920	13,490	13,780	14,920	14,920	
		40.01-60.00	15,870	14,440	14,730	15,870	15,870	

Add.	Code	Spec.	@/P
<p>C0.4-0.6</p>	CC	倒角加工/chamfer process D2 · 2.5時倒角為C0.2-0.4 D2 · 2.5chamfer C0.2-0.4	300
<p>CVC±0.05</p>	CVC	倒角加工/chamfer process $0.2 \leq CVC < \frac{(H-D)}{2} - 0.1$ CVC=0.1mm unit	1000