

# 定位組件 POSITIONING COMPONENTS

塑膠模  
用

## 多板定位鎖locking block sets

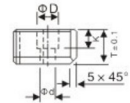
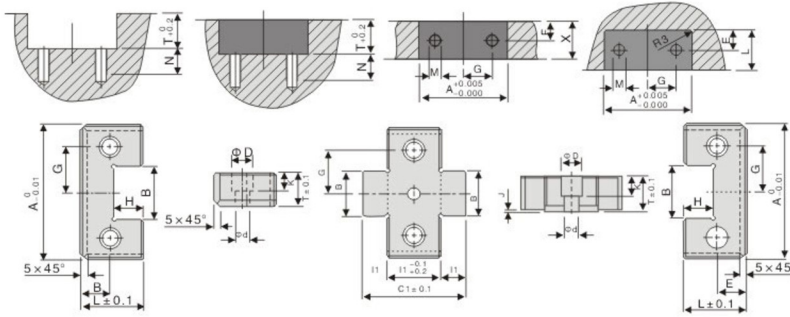

Material M材質	Hardness 硬度
1.7131	HRC55° ~60°

型號/Type	尺寸/dimension																	Price 單價(¥)	
	A	X	B	C1	D	d	E	F	G	h	H	J	K	L	L1	T	M		N
JHN17-5026	50	26	17	43	10.5	6.5	11	13	17	8.5	9.5		8	21.5	26	16	M6	15	400.00
JHN17-5036		36		53				18							36				450.00
JHN17-7526	75	26	25	51			18	13	25	14	15			36	26				500.00
JHN17-7536		36		61				18				1.5			36	19			550.00
JHN17-10036	100	46	35	71	16.5	10.5		23	35				12		46		M10	20	600.00
JHN17-10046		46		81				23							46				650.00
JHN17-12536	125	36	45	71			22	18	42	20	21			45	36	25			700.00
JHN17-12546		46		81				23							46				750.00

## 多板定位鎖 PPLF... PPXM... Locking block sets



Material M材質	Hardness 硬度
8620鋼/brass	HRC50° ~56°

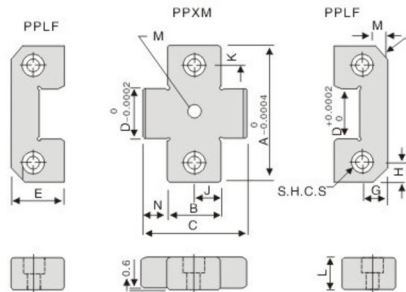

Inch

型號/Type		尺寸/dimension													Price 單價(¥)	
FEMALE	X-STYLE	A	B	C	D	E	內六角螺絲 S.H.C.S	G	H	J	K	L	M	N		U
PPLF-0001	PPXM-1001	1.5000	.850	1.470	.5000	.870	1/4-20 x 3/4	.281	.281	.425	.281	.620	.19	.310	.2500	300.00
(2REQD.)	PPXM-2001		1.350	1.970												350.00
PPLF-0002	PPXM-1002	2.0000	.850	1.470	.6800	.870	1/4-20 x 3/4	.375	.375	.425	.375	.620	.19	.310	.2500	400.00
(2REQD.)	PPXM-2002		1.350	1.970												450.00
PPLF-0003	PPXM-1003	3.0000	.850	1.950	1.0000	1.370	3/8-16 x 1	.668	.375	.425	.375	.745	.19	.550	.3750	500.00
(2REQD.)	PPXM-2003		1.350	2.450												550.00
PPLF-0004	PPXM-2004	4.0000	1.350	1.890	1.3750	1.870	3/8-16 x 1	.875	.625	.675	.625	.745	.50	.770	.3750	600.00
(2REQD.)	PPXM-3004		1.850	3.390												650.00
PPLF-0005	PPXM-2005	5.0000	1.350	2.890	1.7500	1.870	1/2 x 13 x 1/4	.875	.750	.675	.750	1.120	.50	.770	.5000	700.00
(2REQD.)	PPXM-3005		1.850	3.390												750.00